

SIR BENFRO (FFYRDD AMRYWIOL, DINBYCH-Y-PYSGOD)
HYSBYSIAD I DDARPARU NODWEDDION TAWELU TRAFFIG

HYSBYSIR drwy hyn fod Cyngor Sir Penfro, drwy arfer y pwerau o dan adran 90A o Ddeddf Priffyrdd 1980, i ddarparu nodweddion tawelu traffig fel y nodir yn Atodlen isod.

Gellir archwilio copi o'r Hysbysiad ynghyd â'r cynllun perthnasol a'r datganiad o reswm ar-lein yn www.pembrokeshire.gov.uk/TRO-public-notices

Dylid gwneud unrhyw wrthwynebiad neu gynrychiolaeth mewn perthynas â'r cynigion uchod, ynghyd â seiliau'r rhain, naill ai drwy lenwi'r ffurflen adborth ar-lein, neu, yn ysgrifenedig i'r rhai sydd wedi llofnodi isod erbyn 18 Mawrth 2022. Dyfynnwch: **DINBYCH-Y-PYSGOD T/C**

Wedi'i ddyddio y 25ain diwrnod hwn o Chwefror 2022

Darren Thomas
Pennaeth Seilwaith
Cyngor Sir Penfro

ATODLEN
Nodweddion Tawelu Traffig

Cyf	Lleoliad	Math
C3182 Rhodfa'r De		
i)	Ar bwynt 55 metr i'r de o'r gyffordd â'r A4139.	Bwrdd croesi uchel 75mm (lled y gerbyttfordd lawn 3500mm o hyd)
A4139 Ffordd y Parc Uchaf		
ii)	Ar bwynt 12 metr 19m i'r Gorllewin o'r gyffordd â Ffordd Trafalgar.	Bwrdd croesi uchel 75mm (lled y gerbyttfordd lawn 3500mm o hyd)
Ffordd Trafalgar		
iii)	Wrth y gyffordd â Trafalgar Road / Ffordd y Parc Uchaf hyd at bwynt 18 metr i'r de-orllewin o'r gyffordd hon.	75mm o driniaeth croeslin / cyffordd uchel (18000mm o hyd x lled llawn y ffordd gerbydau)

Datganiad o Reswm

Mae'r cynigion yn cael eu hyrwyddo fel rhan o'r Gwelliannau Teithio Llesol ar Ffordd y Parc Uchaf, Ffordd y De a Ffordd Trafalgar, Dinbych-y-pysgod.

Mae'r gwaith yn cael ei ariannu gan Lywodraeth Cymru fel rhan o'r Cynllun Teithio Llesol ac mae'n rhan o becyn o fesurau sy'n cael eu rhoi ar waith yn Dinbych-y-pysgod i wella cysylltedd cerddwyr.

DO NOT SCALE

Millimetres

Low

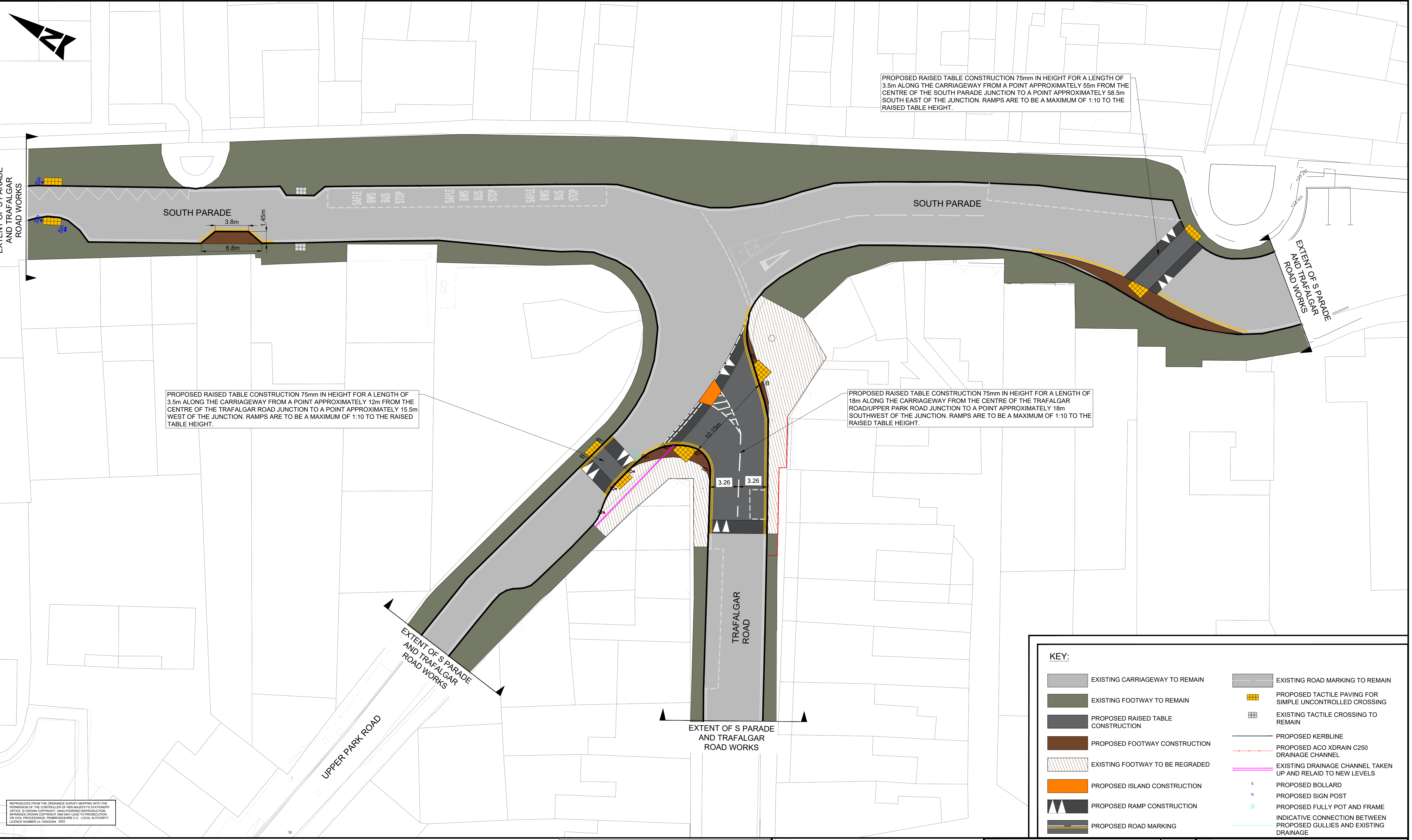
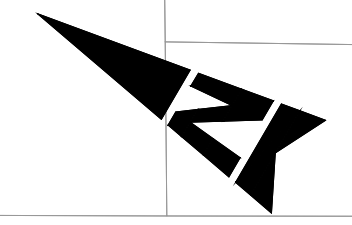

PROPOSED RAISED TABLE CONSTRUCTION 75mm IN HEIGHT FOR A LENGTH OF 3.5m ALONG THE CARRIAGEWAY FROM A POINT APPROXIMATELY 12m FROM THE CENTRE OF THE TRAFALGAR ROAD JUNCTION TO A POINT APPROXIMATELY 15.5m WEST OF THE JUNCTION. RAMPS ARE TO BE A MAXIMUM OF 1:10 TO THE RAISED TABLE HEIGHT.

PROPOSED RAISED TABLE CONSTRUCTION 75mm IN HEIGHT FOR A LENGTH OF 3.5m ALONG THE CARRIAGEWAY FROM A POINT APPROXIMATELY 55m FROM THE CENTRE OF THE SOUTH PARADE JUNCTION TO A POINT APPROXIMATELY 58.5m SOUTH EAST OF THE JUNCTION. RAMPS ARE TO BE A MAXIMUM OF 1:10 TO THE RAISED TABLE HEIGHT.

PROPOSED RAISED TABLE CONSTRUCTION 75mm IN HEIGHT FOR A LENGTH OF 18m ALONG THE CARRIAGEWAY FROM THE CENTRE OF THE TRAFALGAR ROAD/UPPER PARK ROAD JUNCTION TO A POINT APPROXIMATELY 18m SOUTHWEST OF THE JUNCTION. RAMPS ARE TO BE A MAXIMUM OF 1:10 TO THE RAISED TABLE HEIGHT.

KEY:

EXISTING CARRIAGEWAY TO REMAIN	EXISTING ROAD MARKING TO REMAIN
EXISTING FOOTWAY TO REMAIN	PROPOSED TACTILE PAVING FOR SIMPLE UNCONTROLLED CROSSING
PROPOSED RAISED TABLE CONSTRUCTION	EXISTING TACTILE CROSSING TO REMAIN
PROPOSED FOOTWAY CONSTRUCTION	PROPOSED KERBLINE
EXISTING FOOTWAY TO BE REGRADED	PROPOSED ACO XDRAIN C250 DRAINAGE CHANNEL
PROPOSED ISLAND CONSTRUCTION	EXISTING DRAINAGE CHANNEL TAKEN UP AND RELAID TO NEW LEVELS
PROPOSED RAMP CONSTRUCTION	PROPOSED BOLLARD
PROPOSED ROAD MARKING	PROPOSED SIGN POST
	PROPOSED FULLY POT AND FRAME
	INDICATIVE CONNECTION BETWEEN PROPOSED GULLIES AND EXISTING DRAINAGE

REPRODUCED FROM THE ORDNANCE SURVEY MAPPING WITH THE PERMISSION OF THE CONTROLLER OF HER MAJESTY'S STATIONERY OFFICE. © CROWN COPYRIGHT. UNAUTHORISED REPRODUCTION IS PROHIBITED. THIS DRAWING IS FOR INFORMATION ONLY AND IS NOT TO BE USED FOR CONSTRUCTION. ANY PROCEEDINGS IN PROCEEDINGS C.C. LOCAL AUTHORITY LICENCE NUMBER LA 1002334 2022

- GENERAL NOTES:**
- ALL DIMENSIONS ARE IN METRES UNLESS NOTED OTHERWISE.
 - ONLY WRITTEN DIMENSIONS SHALL BE USED, DO NOT SCALE.

SAFETY, HEALTH AND ENVIRONMENTAL INFORMATION

Description		Status	Revision	Drawn	Checked	Reviewed	Authorised	Issue Date
In addition to the hazards/risks normally associated with the types of work detailed on this drawing, note the following significant residual risks (Reference shall also be made to the design hazard log).								
Construction		Status	Revision	Drawn	Checked	Reviewed	Authorised	Issue Date
PROXIMITY TO LIVE UTILITIES INCLUDING UNDERGROUND LOW VOLTAGE CABLES, 11KV UNDERGROUND CABLE, AND LOW PRESSURE GAS MAINS.								
Maintenance / Cleaning		Status	Revision	Drawn	Checked	Reviewed	Authorised	Issue Date
PROXIMITY TO LIVE UTILITIES INCLUDING UNDERGROUND LOW VOLTAGE CABLES, 11KV UNDERGROUND CABLE, AND LOW PRESSURE GAS MAINS.								
Use		Status	Revision	Drawn	Checked	Reviewed	Authorised	Issue Date
NONE								
Decommissioning / Demolition		Status	Revision	Drawn	Checked	Reviewed	Authorised	Issue Date
PROXIMITY TO LIVE UTILITIES INCLUDING UNDERGROUND LOW VOLTAGE CABLES, 11KV UNDERGROUND CABLE, AND LOW PRESSURE GAS MAINS.								

Description		Status	Revision	Drawn	Checked	Reviewed	Authorised	Issue Date
FIRST ISSUE		S0	P01.1					

WORK IN PROGRESS

ATKINS
Member of the SNC-Lavalin Group

West Glamorgan House
12 Orchard Street
Swansea
West Glamorgan
SA1 5AD

Tel: +44 (0)1792 641172
Fax: +44 (0)1792 472019
www.atkinsglobal.com

Copyright © SNC Lavalin (2022)

PEMBROKESHIRE COUNTY COUNCIL

Project Title: Tenby SUP Golf Club to Park Road Phase 2

Project: PE10_302 - ATK - HGN - SWMWRCS - DR - CH - 000008

Drawing Title: SOUTH PARADE / TRAFALGAR ROAD / UPPER PARK ROAD TRAFFIC CALMING ARRANGEMENT

Client: PEMBROKESHIRE COUNTY COUNCIL

Original Size: A1 | Scale: 1:200 | Project Ref. No: 5207407 | Sheet: 1 of 1 | Rev: P01.1